

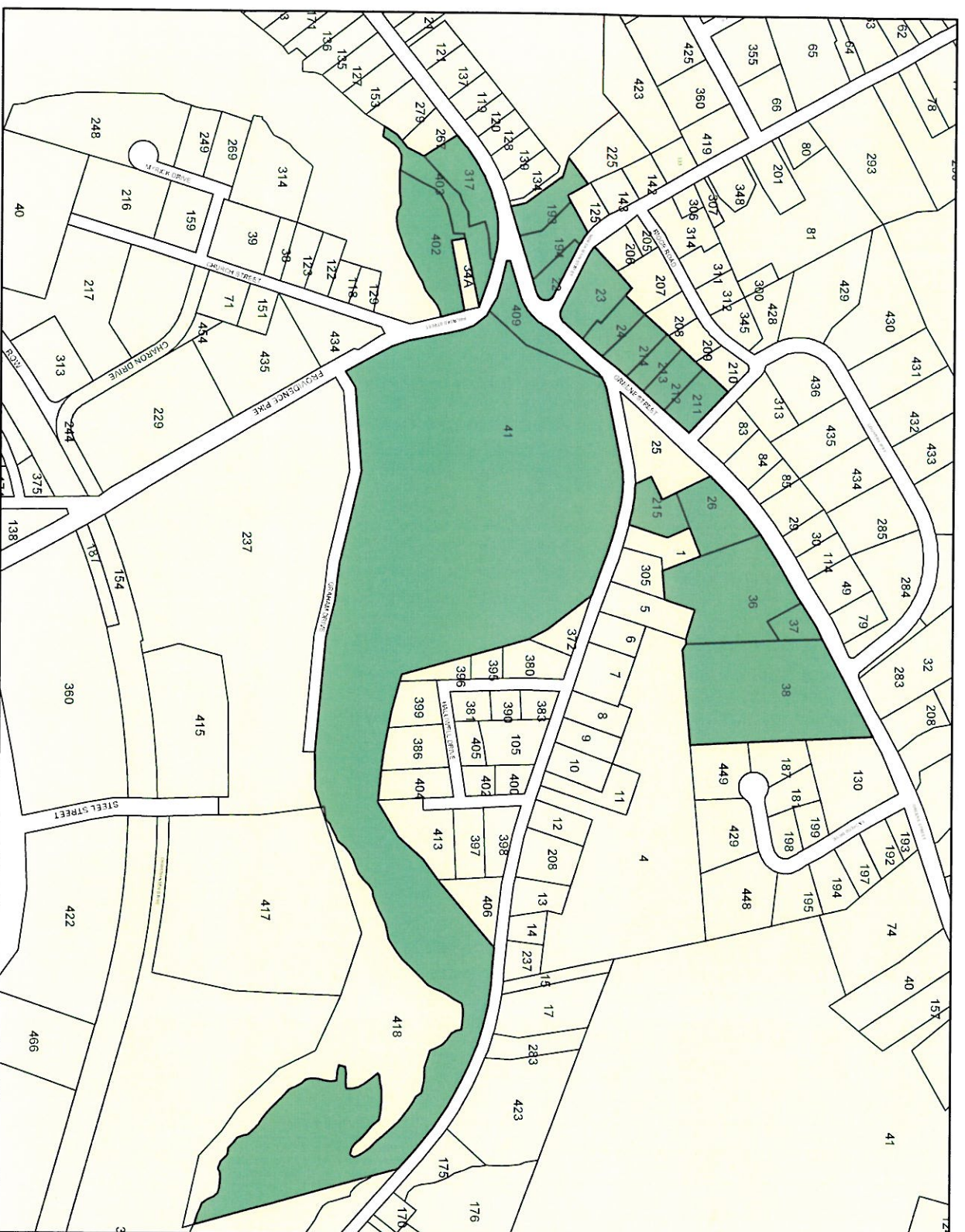

Slatersville Historic District

All lots are in
Plat 4, except
Lots 36, 37 & 38
are in Plat 2

Lot 25
(Congregational Church)
has been omitted

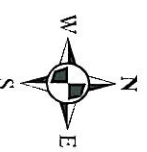

Map created by
North Smithfield, RI
Planning Department
7/11/12

1 inch = 0.09 miles
Adopted October 15, 2012

"The inclusion of the Slatersville Historic District as a designated historic district pursuant to §9-4(a) of the North Smithfield Code of Ordinances shall cease and terminate effective November 30, 2014 (the "Sunset Date"), unless the Town Council by affirmative vote on or before the Sunset Date shall extend the Sunset Date or eliminate this restriction from the Slatersville Historic District Map to which it is appended. Any such extension or elimination shall be subject to the then controlling advertising and public hearing requirements relating to zoning changes in general to be enacted by the Town Council at the time of such vote."

Historic District Parcels selection

Other Parcels

Legend

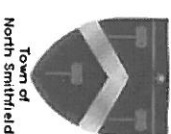

Slatersville Historic District

All lots are in
Plat 4, except
Lots 36, 37 & 38
are in Plat 2

Lot 25
(Congregational Church)
has been omitted

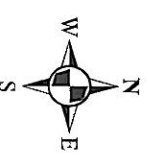

Legend



Historic District Parcels selection



Other Parcels

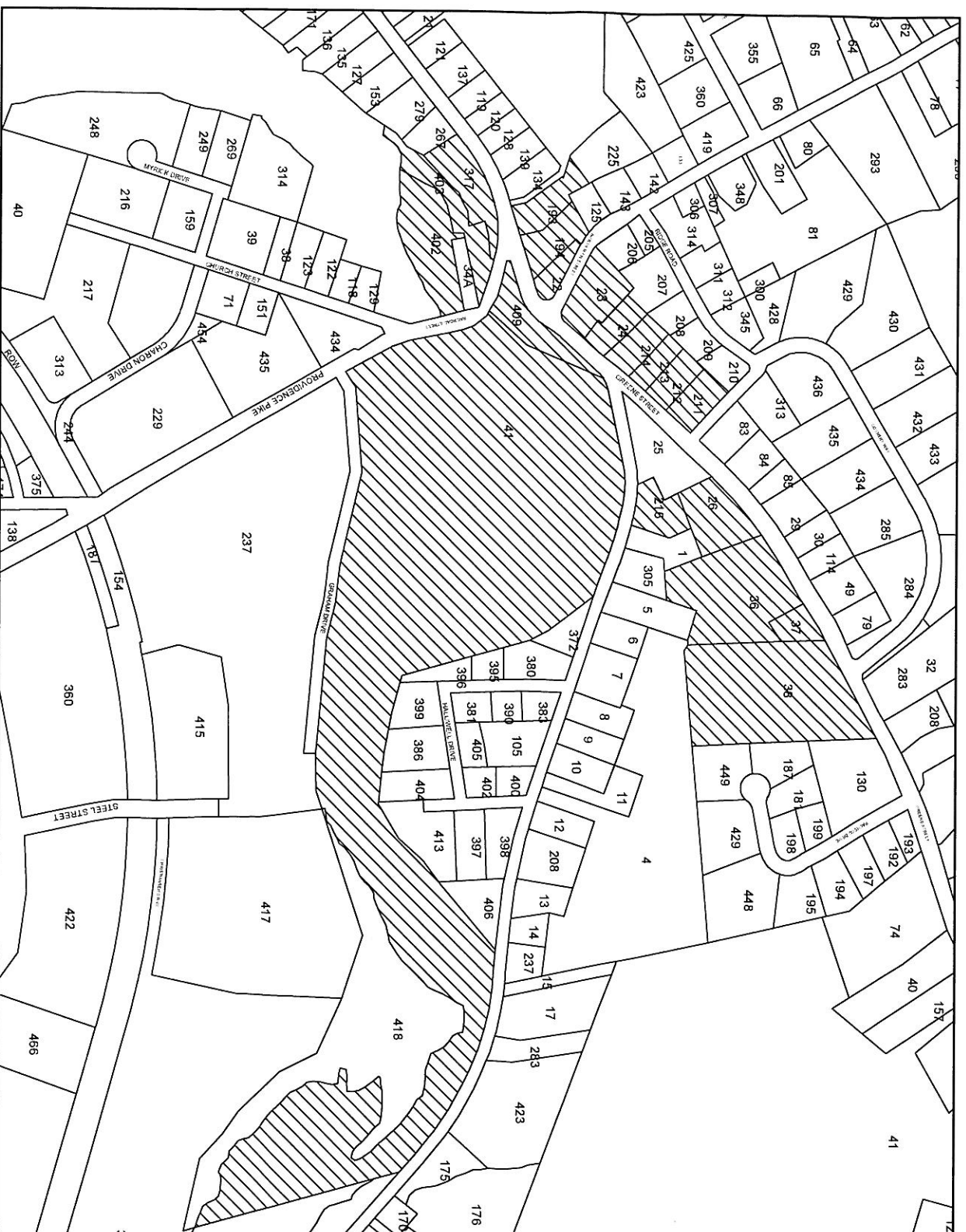

Map updated by

North Smithfield, RI

Planning Department

8/9/12

1 inch = 0.09 miles

Adopted October 15, 2012

“The inclusion of the Slatersville Historic District as a designated historic district pursuant to §9-4(a) of the North Smithfield Code of Ordinances shall cease and terminate effective November 30, 2014 (the “Sunset Date”), unless the Town Council by affirmative vote on or before the Sunset Date shall extend the Sunset Date or eliminate this restriction from the Slatersville Historic District Map to which it is appended. Any such extension or elimination shall be subject to the then controlling advertising and public hearing requirements relating to zoning changes in general to be enacted by the Town Council at the time of such vote.”